



**FOOD USE
WORKSHOP**
September 10 - 12, 2024

AGENDA

Renaissance Milwaukee West Hotel | Wauwatosa, WI

***Times are in Central Time (CT) and are fluid and subject to change—check your email for updates.*

Day One: Tuesday, September 10, 2024

Time (Central Time)	Session	Location
7:00 – 8:00 a.m.	– Coffee and Breakfast –	Revel Hall Pre-Function, Haute & Couture
7:00 – 8:00 a.m.	Registration	Revel Hall Pre-Function
8:00 – 8:10 a.m.	Introduction	Revel Hall
8:10 – 8:15 a.m.	Welcome from IR-4 Project Management Committee Chair	
8:15 – 8:50 a.m.	IR-4 Project Update	
8:50 – 9:20 a.m.	Commodity Liaison Committee Update	
9:20 – 9:30 a.m.	USDA National Institute of Food and Agriculture (NIFA) Update	
9:30 – 10:00 a.m.	– Break and Refreshments –	Revel Hall Pre-Function
10:00 – 11:00 a.m.	US EPA Update	Revel Hall
11:00 – 11:10 a.m.	Awards & Recognition	
11:10 – 11:30 a.m.	Attendee Introductions	
11:30 a.m. – 1:00 p.m.	– Lunch –	Botanic + Belvedere (12th level)

Priority Setting Begins		
1:00 – 3:00 p.m.	Priority Setting: Weed Science (Residue and Product Performance)	Revel Hall
3:00 – 3:30 p.m.	– Break and Refreshments –	Revel Hall Pre-Function
3:30 – 5:00 p.m.	Priority Setting: Weed Science (Integrated Solutions)	Revel Hall
5:30 – 7:30 p.m.	Reception at Hotel	Botanic + Belvedere (12th level)

Day Two: Wednesday, September 11, 2024

***Times are in CT and are fluid and subject to change—check your email for updates.*

Time (Central Time)	Session	Location
7:00 – 8:00 a.m.	– Coffee and Breakfast –	Revel Hall Pre-Function, Haute & Couture
8:00 – 9:30 a.m.	Priority Setting: Entomology (Residue and Product Performance)	Revel Hall
9:30 – 10:00 a.m.	– Break and Refreshments –	Revel Hall Pre-Function
10:00 – 11:30 a.m.	Priority Setting: Entomology (Integrated Solutions)	Revel Hall
11:30 a.m. – 1:00 p.m.	– Lunch –	Botanic + Belvedere (12th level)
1:00 - 2:00 p.m..	Integrated Solutions Listening Session	Revel Hall
2:00 – 3:00 p.m.	Priority Setting: Plant Pathology (Residue and Product Performance)	Revel Hall
3:00 – 3:30 p.m.	– Break and Refreshments –	Revel Hall Pre-Function
3:30 – 4:30 p.m.	Priority Setting: Plant Pathology (Integrated Solutions)	Revel Hall
4:30 - 5:00 p.m.	Priority Discussions	

Day Three: Thursday, September 12, 2024

***Times are in CT and are fluid and subject to change—check your email for updates.*

Time (Central Time)	Session	Location
7:00 – 8:00 a.m.	– Coffee and Breakfast –	Revel Hall Pre-Function, Haute & Couture
8:00 – 10:00 a.m.	Finalize Priorities: All Disciplines	Revel Hall
10:00 – 10:30 a.m.	– Break and Refreshments –	Revel Hall Pre-Function
10:30 – 12:00 noon	Finalize Priorities: All Disciplines	Revel Hall

Notes

Conference Wifi Network | Renaissance_Conference

Wifi password | 2024FUW

Event Location:

Renaissance Milwaukee West Hotel
2300 N Mayfair Rd, Wauwatosa, WI 53226



***Parking is complimentary for conference attendees!*

In-person attendees on Zoom:

If you are connecting to Zoom, please do not connect to the Zoom audio! This will help us prevent audio feedback.

Name Badge Flags:

Looking for a particular registrant or speaker? To make it easier for you to find who you are looking for, this year we have included name badge flags for:

SPONSOR, **PRESENTER**, and **IR-4 STAFF**.

Sustainability:

As part of our commitment to sustainability, we have provided reusable plastic cups for the meeting. Please make sure to use these cups instead of disposable ones to help reduce waste. Thank you for your cooperation in making our meeting more eco-friendly!

Event Materials:



Event Materials will be updated **daily** and posted on our event web page (below). Registered attendees will also receive an email (to the email address provided during registration) when updated materials are posted.

Event Web Page: ir4project.org/events/2024-food-use-workshop/

After the workshop, we ask that you please complete our **Post Meeting Survey** by scanning this QR Code. We appreciate your feedback as it helps to improve future events!

How to scan the QR Code on your smartphone:

1. Open the built-in camera app.
2. Point the camera at the QR code.
3. Tap the banner that appears on your screen and this will take you to the survey.

***Alternatively, a link will be sent out to all participants in a post-event email.*



Scan to complete FUW Survey

Maps of Venue & Reception Location

General Session Map

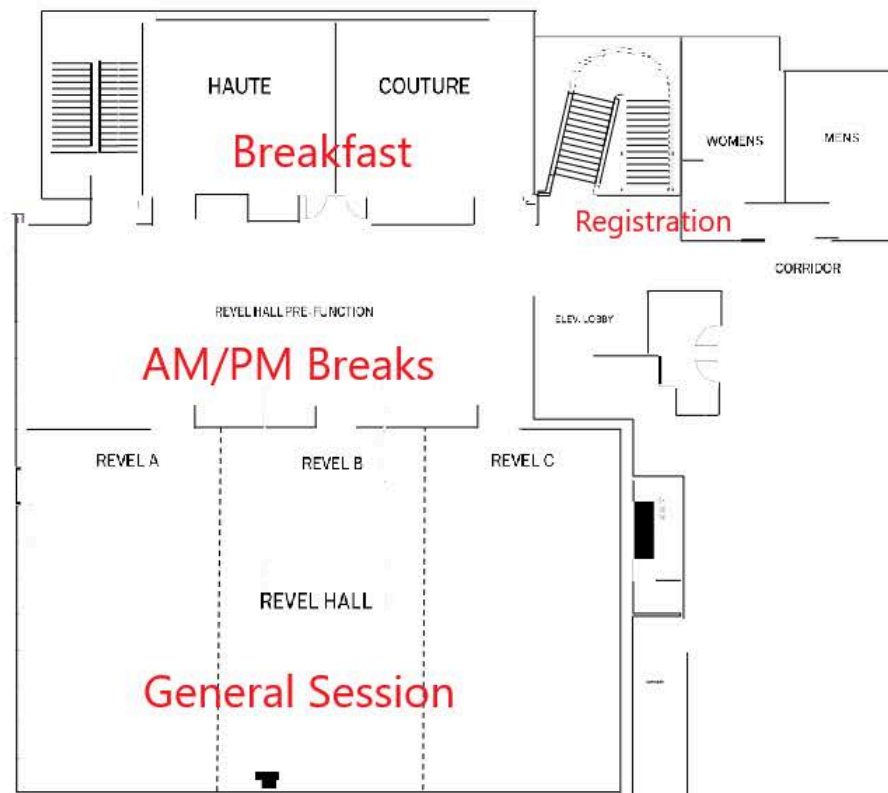

12th Floor Map

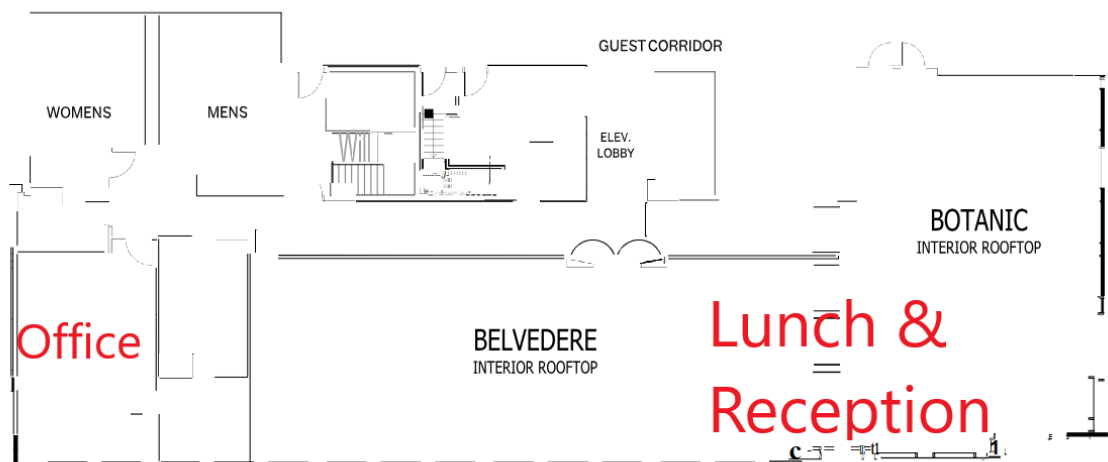

THANK YOU, SPONSORS

Thank You, 2024 Event Sponsors!

 Platinum



 Gold



 Silver



 Bronze

We hope you've enjoyed the workshop!

Event Web Page | ir4project.org/events/2024-food-use-workshop/



Scan to view the event web page—prioritization lists will be posted here.